

2D OVERALL

WALLS TO BE CLEAR & FREE OF ANY OBSTRUCTIONS PRIOR TO INSTALLATION

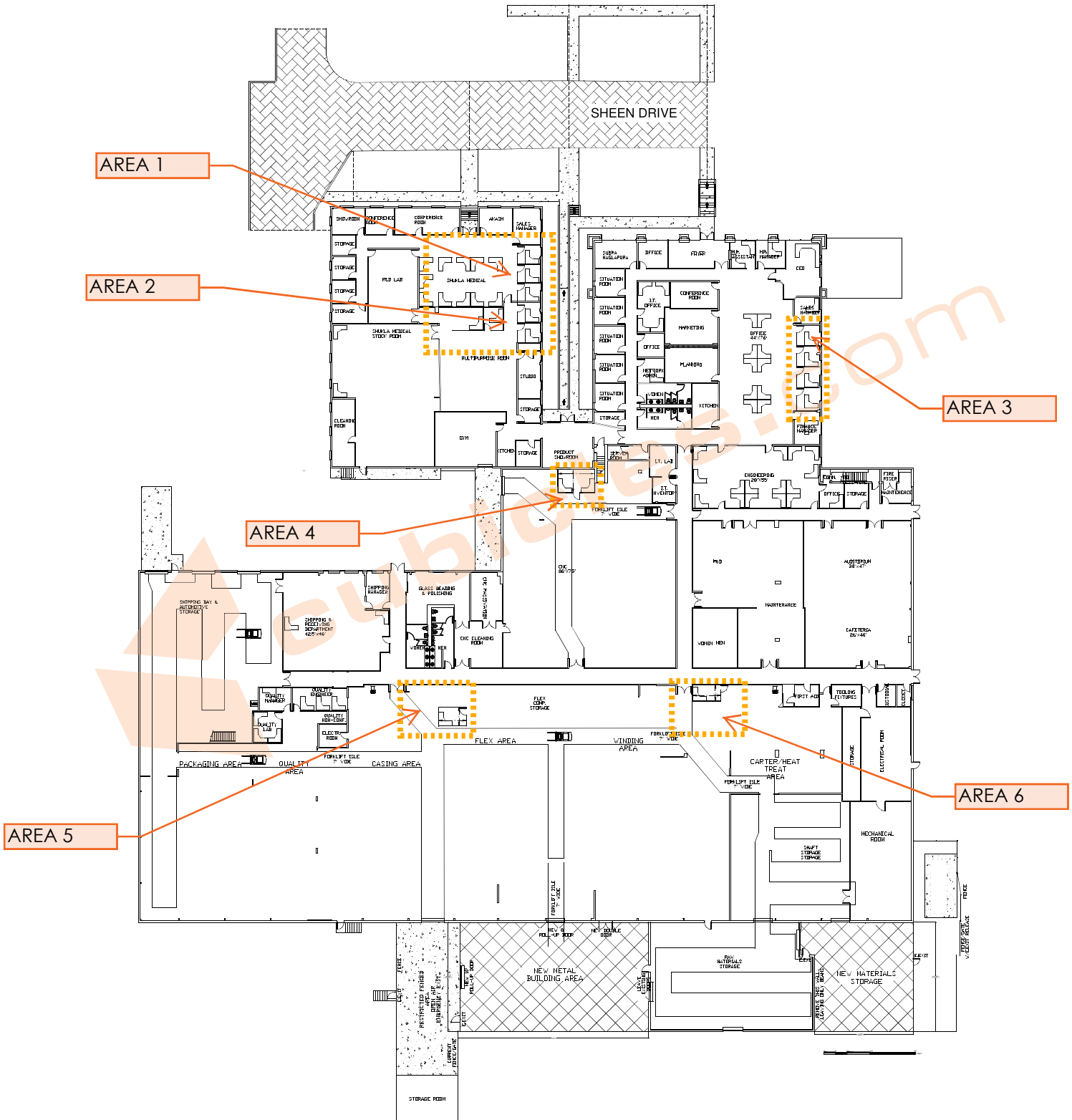

AREA 1 - 2D LAYOUT

O2™ Modular Office Walls

• AREA 1

[2] 7'8"X9'7" Non-Powered

[1] 8'9"X9'7" Non-Powered

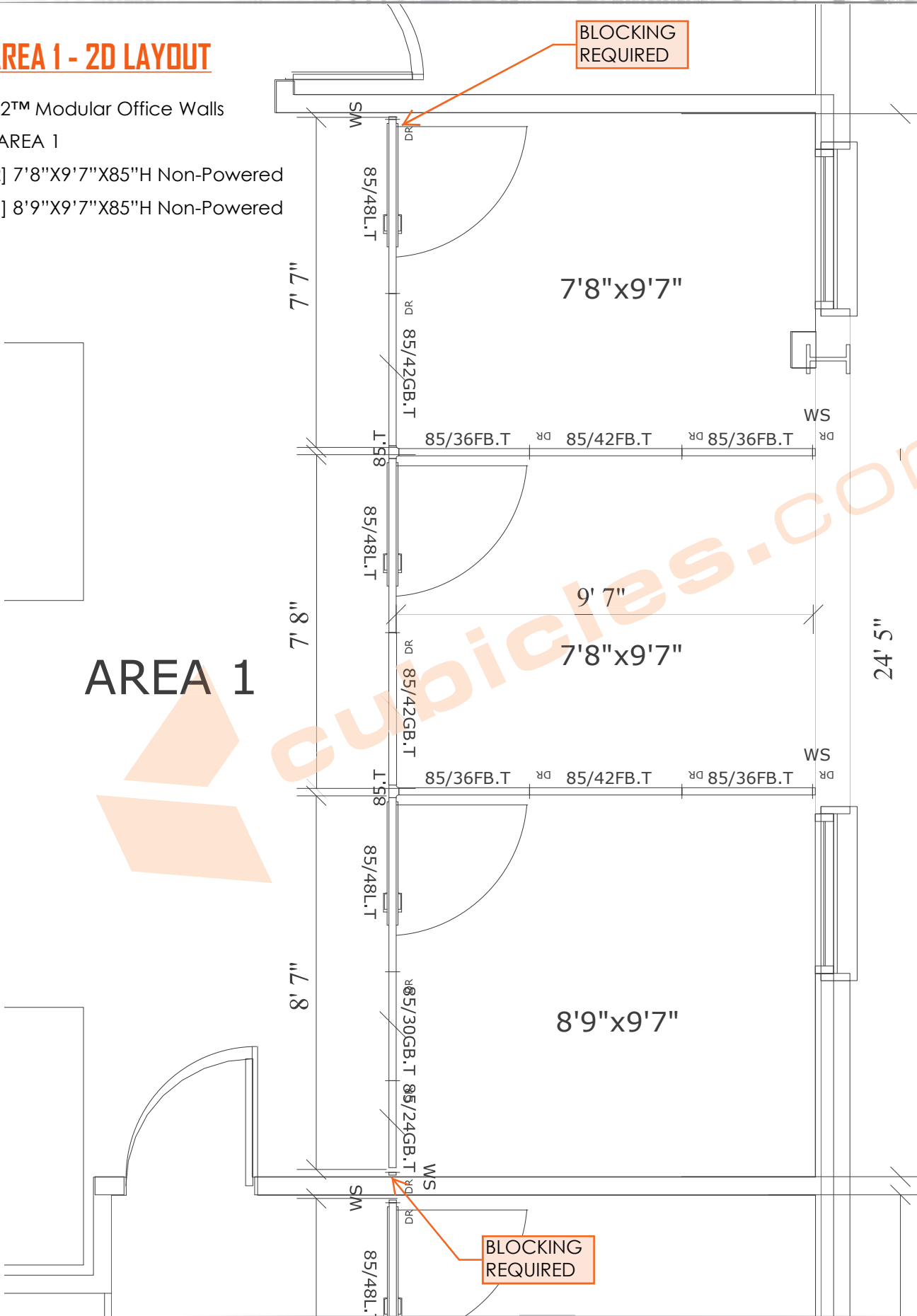

AREA 2 - 2D LAYOUT

O2™ Modular Office Walls

- AREA 2

[1] 9'2"X9'7"X85"H Non-Powered

[1] 8'4"X9'7"X85"H Non-Powered

[1] 16'5"X6'8"X85"H Non-Powered

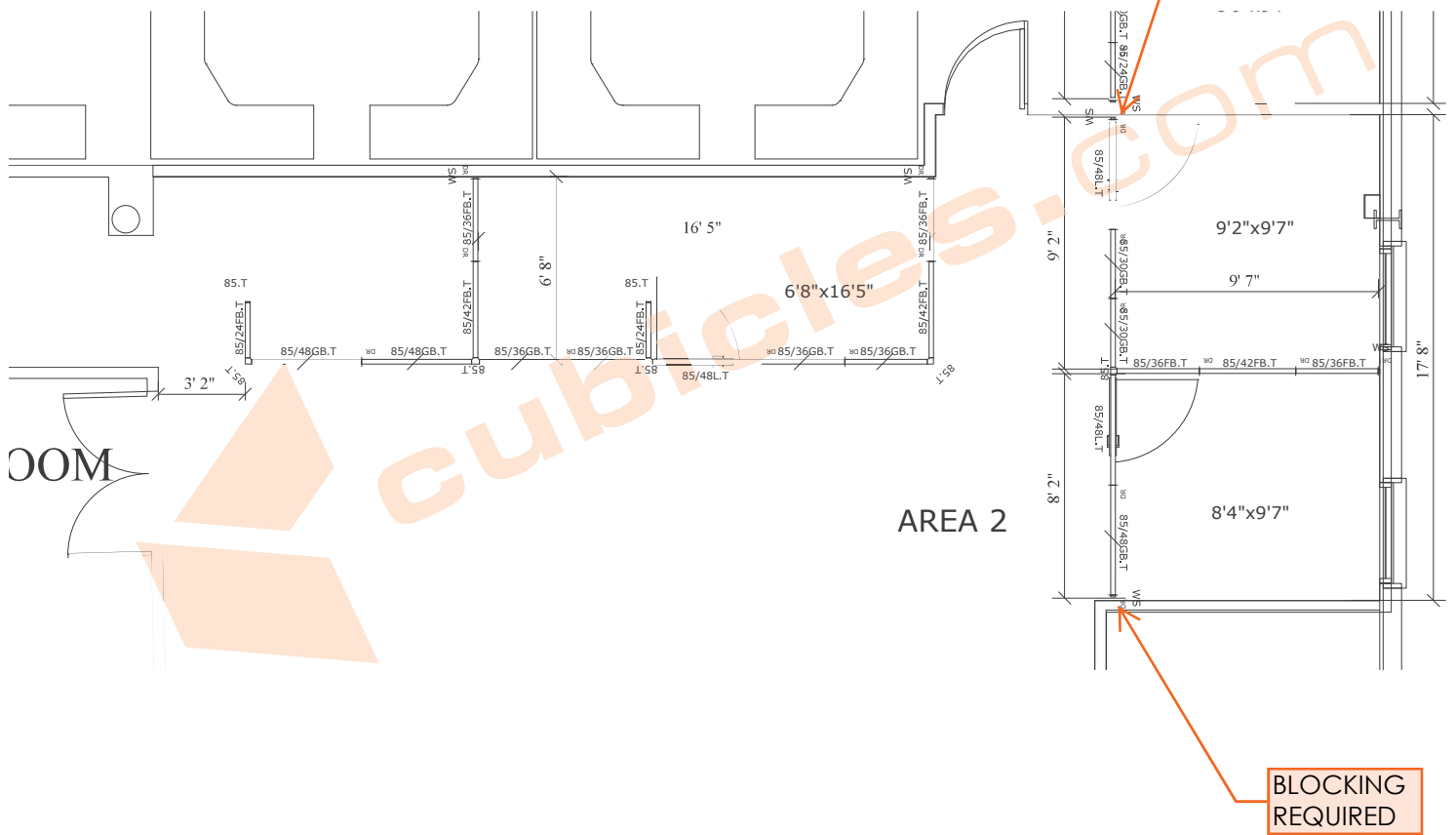

BLOCKING
REQUIRED

AREA 3 - 2D LAYOUT

O2™ Modular Office Walls

• AREA 3

[1] 10'3"X9'7"X85"H Non-Powered

[1] 7'8"X9'7"X85"H Non-Powered

[1] 8'1"X9'7"X85"H Non-Powered

[1] 10'10"X9'7"X85"H Non-Powered

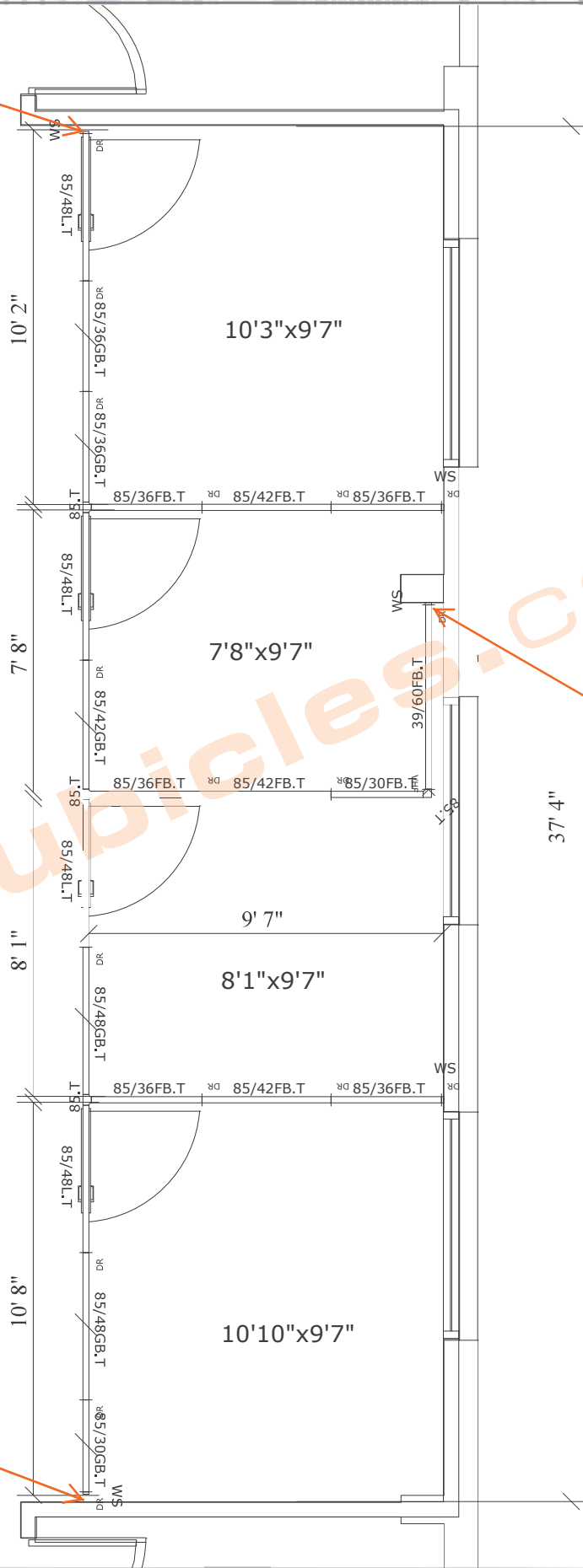

PENDING SITE
VERIFICATION
OF CONDITION

AREA 3

BLOCKING
REQUIRED

AREA 4 - 2D LAYOUT

O2™ Modular Office Walls

• AREA 4

[1] 9'7"X16'5"X85"H Non-Powered

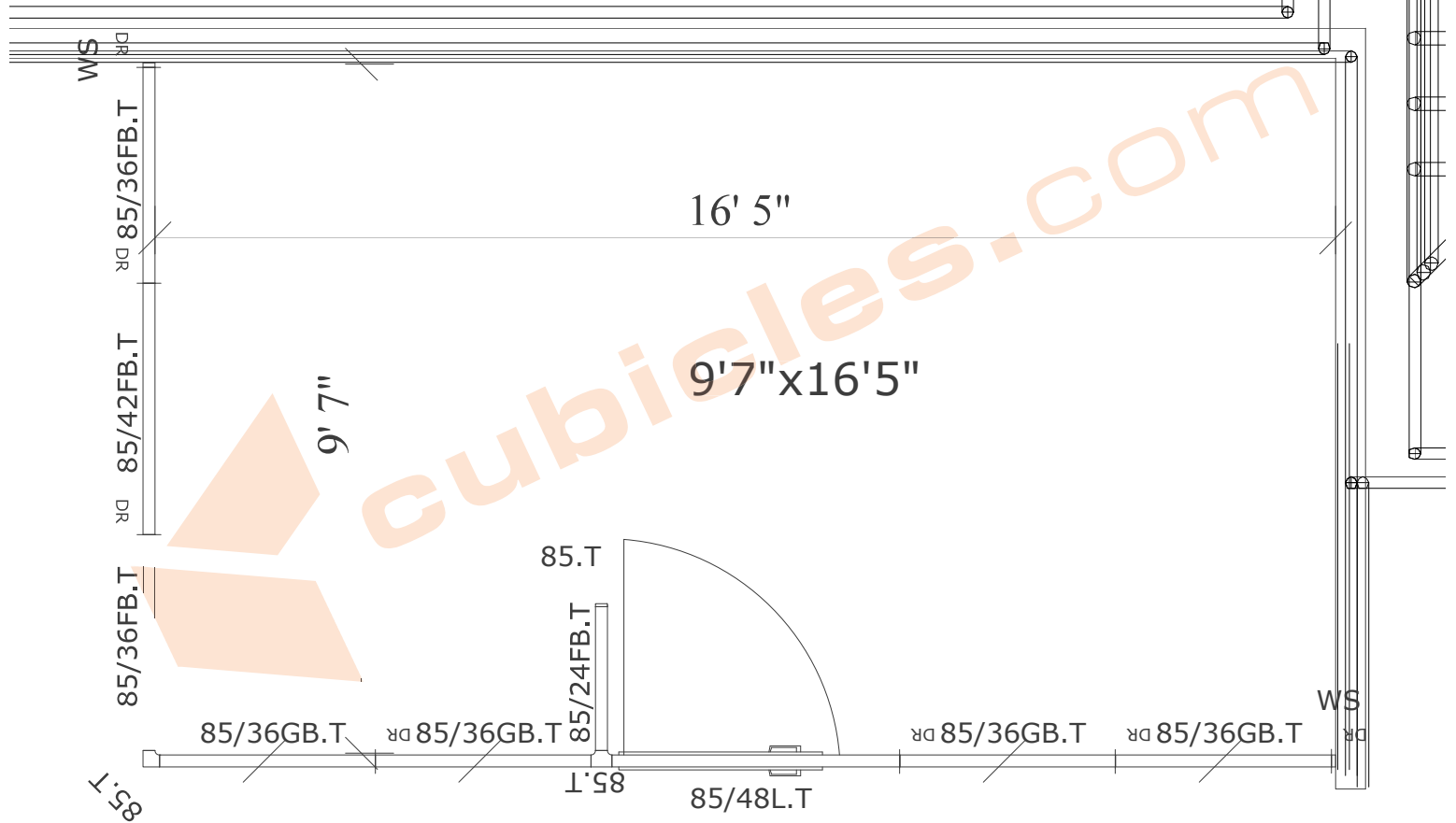

AREA 4

AREA 5 - 2D LAYOUT

O2™ Modular Office Walls

• AREA 5

[1] 9'7"X8'3"X85"H Non-Powered

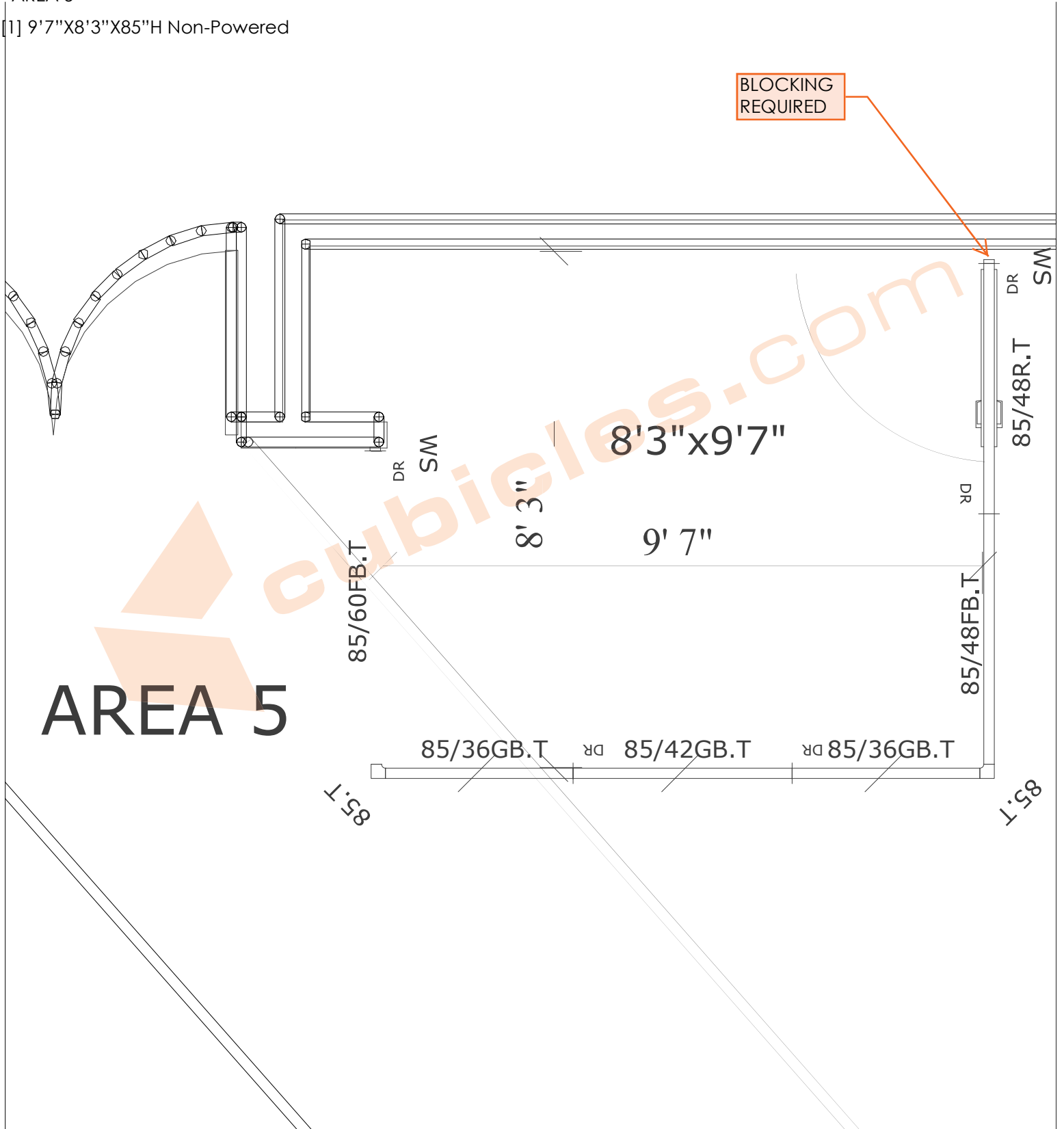

AREA 6 - 2D LAYOUT

O2™ Modular Office Walls

• AREA 6

[1] 9'7"X8'2"X85"H Non-Powered

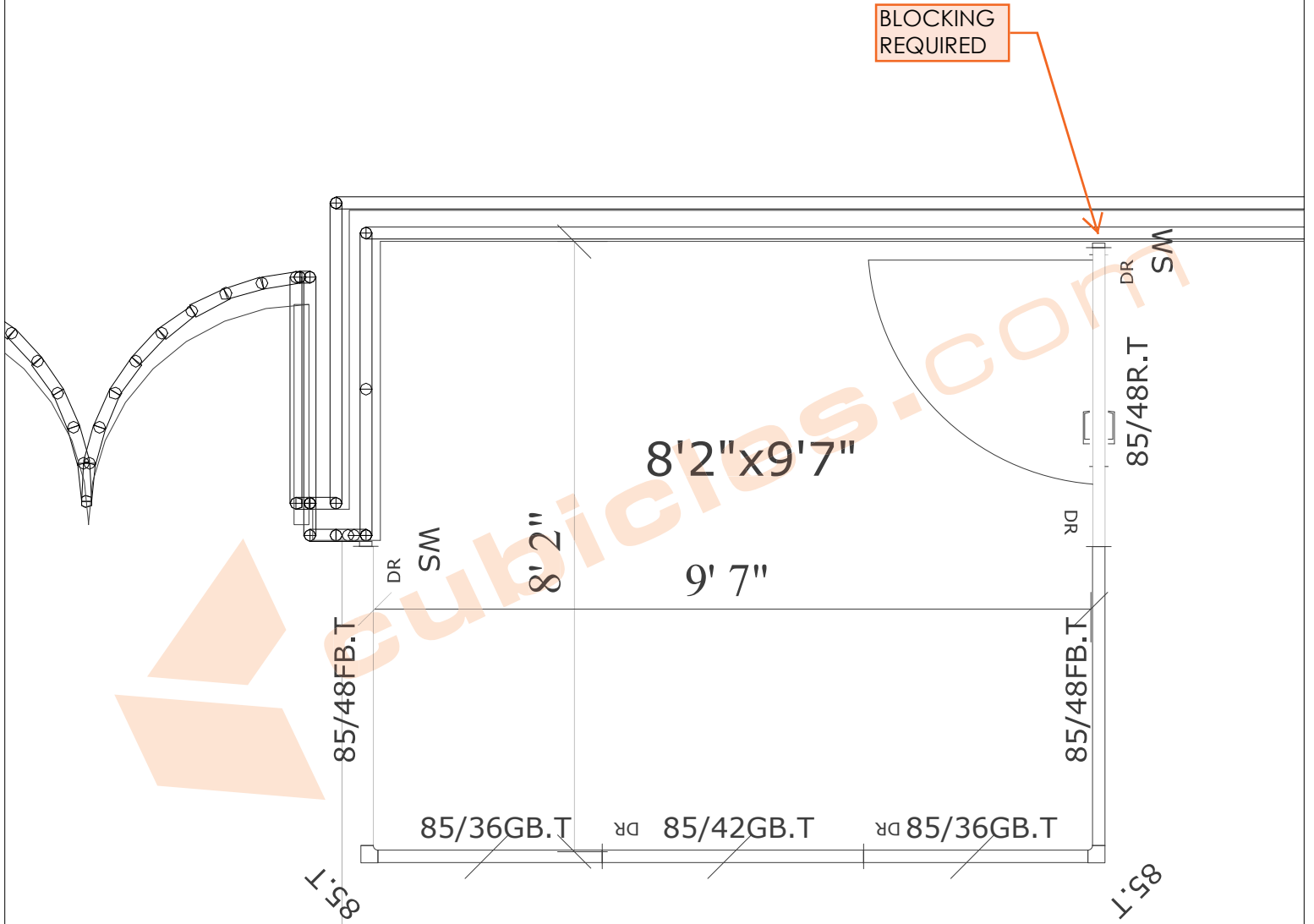

AREA 6