

OVERALL LAYOUT 2D

SCOPE:

Executive Office 100:

[1] 7'x9' U-Shaped Desk with Box Box File Pedestal and Lateral File.

[1] Task Chair and [2] Guest Chairs.

Lounge Area with [1] Sofa (not in scope), [2] Lounge Chairs. [1] 27.6"Dia x 17.7"H & [1] 19.7" W x 15.7" H Occasional Tables.

Pantry/Lounge 103:

[4] Lounge Chairs

[1] 39" Dia x 14.5"H Table

Board Room 104:

[1] 48"x216" Powered Conference Table

[16] Conference Room Chairs

Offices 105-108, 111-114, 116, 118, 120-121, 124-126:

[1] 6'x6'6" L-shaped Desk with Box Box file and File File Pedestal.

[1] Task Chair and [2] Guest Chairs.

Reception 109:

[2] Lounge Chair

[1] 19"Dia x 20"H Side Table

[1] Task Chair

Office 115 and 128:

[1] 8'x6' U-shaped Desk with Box Box File Pedestal and Lateral File.

[1] Task Chair and [2] Guest Chairs.

Seating Area with [1] Sofa only for 115.

Seating Area with [1] Lounge Chair and [1] 19"Dia x 20"H Side Table only for 128.

Conference Room 119:

[1] 48"x120" Powered Conference Table

[1] 72"x24" Serving Credenza

[10] Conference Room Chairs

Open Area 123 and 127:

[1] 6'x12' Powered Workstation + [1] 6'x2' Print Area + [2] 6'x6' Powered Workstations reconfigured from existing cubicles.

[3] Task Chairs.

Office 129:

[1] 6'x9' Existing Right Return Desk

[1] Task Chair and [1] Guest Chair

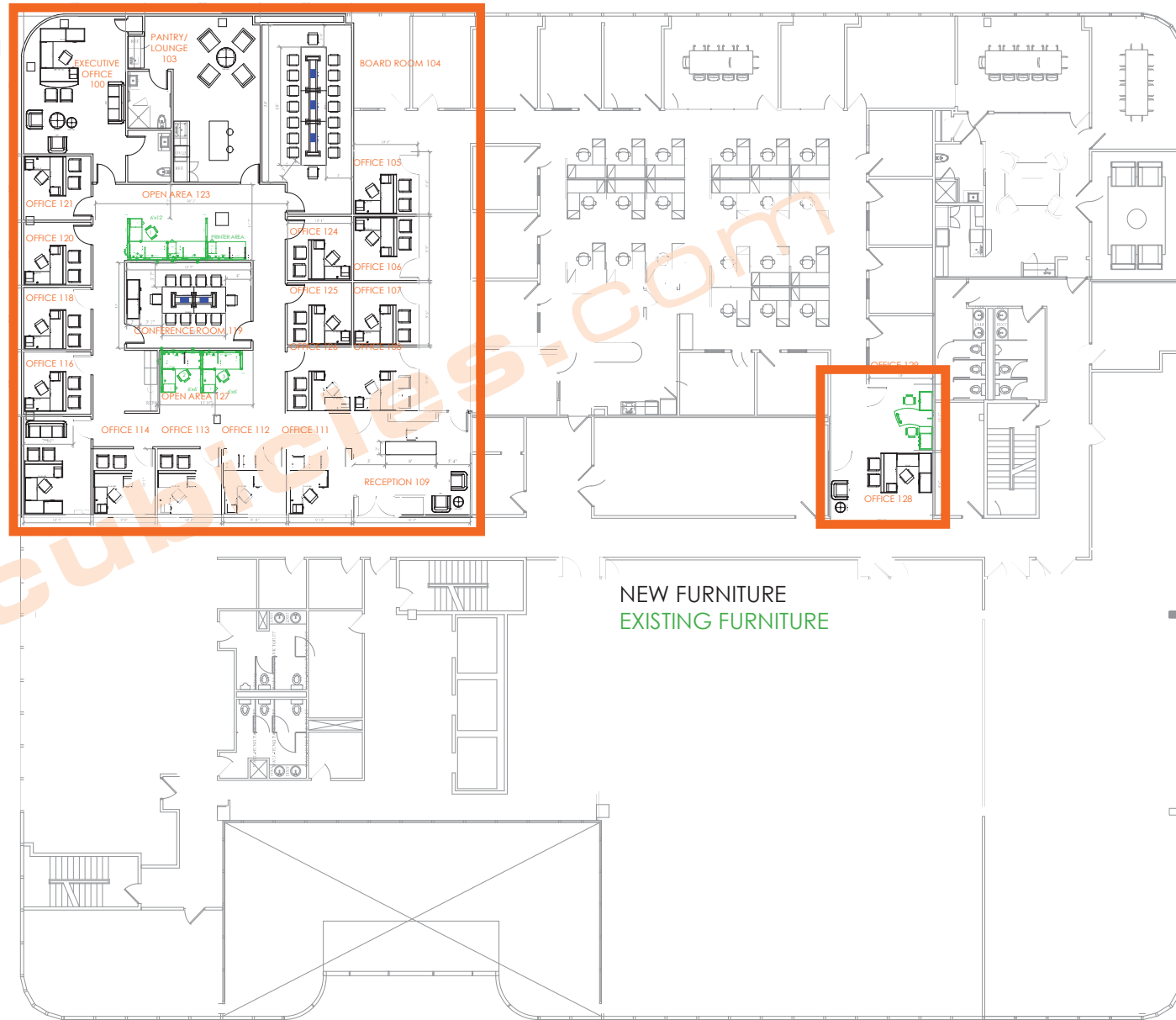

*DIMENSIONS PROVIDED BY CLIENT, TO BE FIELD VERIFIED.