

## 2D & 3D BLOW-UP LAYOUTS | ACCOUNTING DEPARTMENT MODULAR OFFICE FURNITURE | POWERED

### SCOPE:

[2] 6'X7'X39"H POWERED WORKSTATION

MAIN WORKSURFACE 24"X72" HEIGHT ADJUSTABLE

### ACCESSORIES:

[1] BOX BOX FILE PEDESTAL & [1] POWER HUB /EA

[1] 72"X24" LAMINATE STORAGE UNIT W/ 2-DRAWER LATERAL FILES

\*SEATING NOT INCLUDED. AVAILABLE UPON REQUEST.

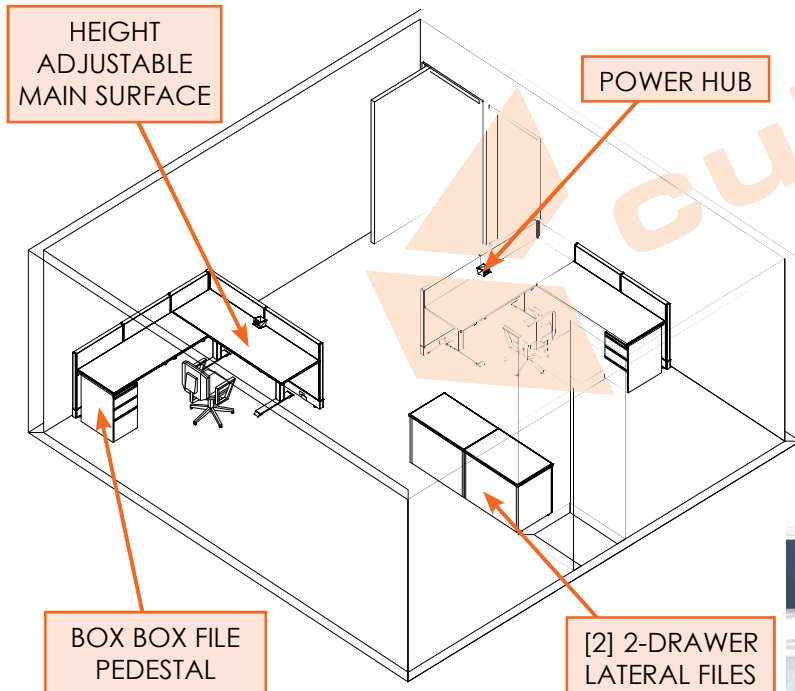
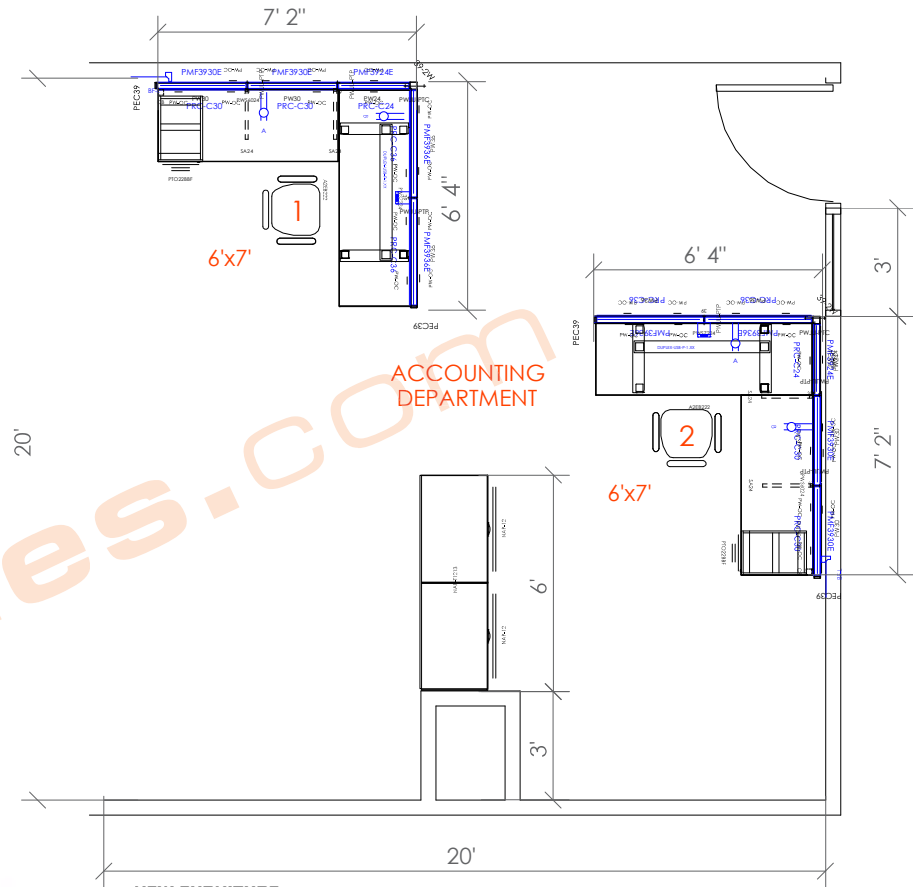

### FINISHES:



### NEW FURNITURE ELECTRICAL

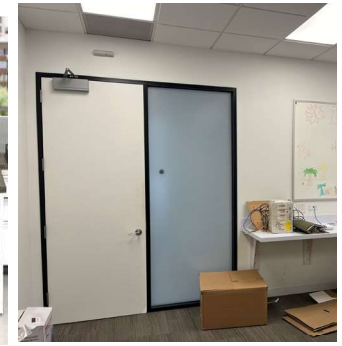

IMAGES FOR REFERENCE ONLY. NOT SPECIFIC TO THE PROJECT.

IMAGE OF EXISTING SPACE